

# Memorial Courtyard Giving Opportunities

We deeply appreciate the financial support provided by early donors to develop the courtyard. Friends of Holy Wisdom are broadly invited to participate in completion of this sacred space. Please consider a gift to one or more of the following project elements.

## Project Elements

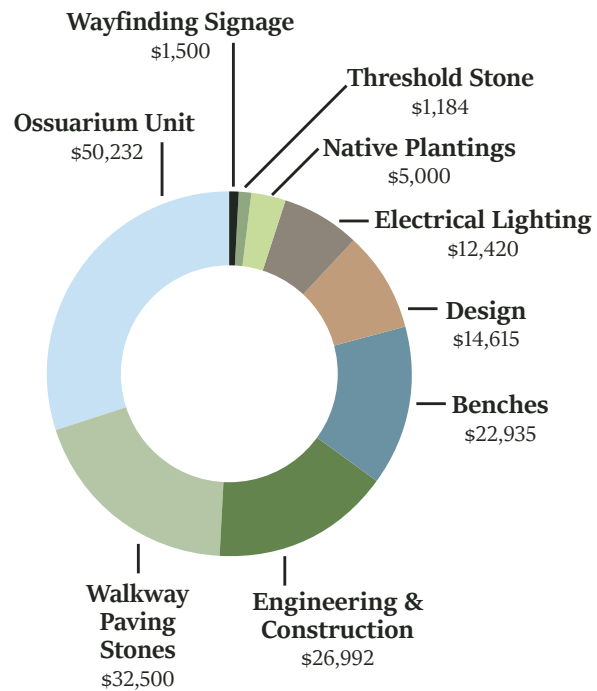

Project Budget: \$ 167,378  
 Amount Raised:\* \$ 101,165

**Ministry Fundraising Goal: \$ 66,213**

\*as of Oct 18, 2021

	Single Occupancy	Double Occupancy
<b>Ossuarium Niche</b>		
Heavenly Level (row 1)	\$ 4,495	\$ 6,495
Internal Vault***	\$ 2,495	NA
Heart Level (row 3)	\$ 3,995	\$ 5,995
Hand Level (row 4)	\$ 3,495	\$ 5,495
<b>Columbarium Wall Niche</b>		
Heavenly Level (row 3)	\$ 4,495	\$ 6,495
Heart Level (rows 4-5)	\$ 3,995	\$ 5,995
Hand Level (rows 6-7)	\$ 3,495	\$ 5,495

\*Prices are subject to change  
 \*\*Installment payment plan available upon request  
 \*\*\*Ossuary inscriptions listed on row 2 facade

For more information on how to reserve interment space or make a gift to support the Memorial Courtyard project, contact:

**Nancy Sandleback**  
 nsandleback@holywisdommonastery.org  
 608-836-1631, x 105



**LEARN MORE**  
[holywisdommonastery.org/memorial-courtyard](https://holywisdommonastery.org/memorial-courtyard)

Scan Me



**DONATE**  
[holywisdommonastery.org/support/donate-today](https://holywisdommonastery.org/support/donate-today)



The west-facing Memorial Courtyard, located behind the monastery, overlooks Lost Lake. The peaceful and beautiful setting invites solitary contemplation and a welcoming space for gatherings of family and friends to remember loved ones.



*Holy Wisdom Monastery*  
 Weaving prayer, hospitality, justice and care  
 for the earth into a shared way of life.

HolyWisdomMonastery.org

4200 County Road M Middleton, WI 53562-2317  
 608-836-1631, x105



*Holy Wisdom Monastery*



Welcome to  
**Holy Wisdom Memorial Courtyard**

## About Holy Wisdom Memorial Courtyard

Holy Wisdom aspires to ever greater levels of hospitality. The monastery land has long been sacred ground and our guests experience this quality when they visit.

In seeking ways to expand its service to the Sisters' community, Sunday Assembly, Oblates, Friends of Wisdom Prairie, coworkers and other stakeholders, the Benedictine Women of Madison identified the need to expand interment space for the cremated remains of loved ones.

This space will serve as a ministry to individuals and families with an immediate need and those who seek peace by pre-planning their final resting place in advance. It is a privilege to extend Benedictine hospitality and comfort to those who are grieving.

*“They’re building on an old story, in a new way. ‘That all may be one’ inspires me – families have a sacred space for their loved ones and may God bring us all together to everlasting life.”*

– Norma Madsen, Donor & Volunteer

**Columbarium:** A structure for the respectful storage of cremated remains.

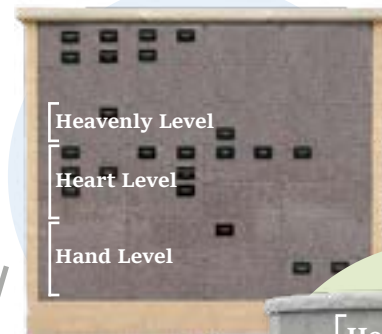

**Ossuarium:** A freestanding granite structure that includes niches and an ossuary vault for communal burial.



## Did You Know?

According to a 2018 study by the National Funeral Home Directors Association, 60% of Wisconsin residents chose cremation over traditional burial and this rate is expected to increase to 80% by 2035.

